

RESOLUTION #2024-03  
ESTABLISH FOUR WARDS

RESOLUTION TO ESTABLISH FOUR WARDS TO COMPLY WITH THE ASSEMBLY AND SENATE DISTRICTS IN THE TOWN OF AZTALAN, JEFFERSON COUNTY, WISCONSIN

**WHEREAS**, 2023 Wisconsin Act 94 was enacted on February 19, 2024 which established newly created Assembly and Senate Districts; and

**WHEREAS**, Section 5.15(6)(a) of Wisconsin Statutes dictates that “no ward line adjustment may cross the boundary of a congressional, assembly or supervisory district”; and

**WHEREAS**, 2023 Wisconsin Act 94 divides the Town of Aztalan Ward 3 into two portions, thereby requiring the Town to modify Ward 3 and create Ward 4 as shown in Exhibit A, and;

**NOW, THEREFORE, BE IT HEREBY RESOLVED** that Town of Aztalan, Jefferson County, State of Wisconsin, hereby adopts the wards described as follows in Exhibit B, and

**BE IT FURTHER RESOLVED**, that Wards 1 - 4 created above are hereby combined for voting purposes, so as to share the common polling place of Aztalan Town Hall, W6260 County Road B, Jefferson, WI and such combined wards shall use common ballot boxes and ballots or voting machines and separate returns shall not be maintained for the combined wards at any election, except where separate ballots are required under Section 5.58 - 5.64 of the Wisconsin State Statutes, and separate ballots or voting machines shall be maintained for any electors of one or more of the combined ward who are ineligible to vote for any office or referendum for which other electors in the combined wards may vote;

**BE IT FURTHER RESOLVED**, that upon passage, a copy of this resolution shall be filed with the Town Clerk, who shall transmit a copy of the ward plan and this resolution to the County Clerk within five days of its adoption and that this resolution shall remain in effect for each election until modified or rescinded, in accordance with Statute, or until a new division is made following the next federal decennial census.

This Resolution shall be in effect upon approval by the Town Board.

Dated this the 10<sup>th</sup> day of April, 2024 by:

  
Jeremy Chwala, Town Chairman

  
Larry Christianson, Supervisor

  
Megan Dunneisen, Supervisor

Attest:   
Kathleen Pitzner, Town Clerk



Town of Aztalan Wards 4/10/2024

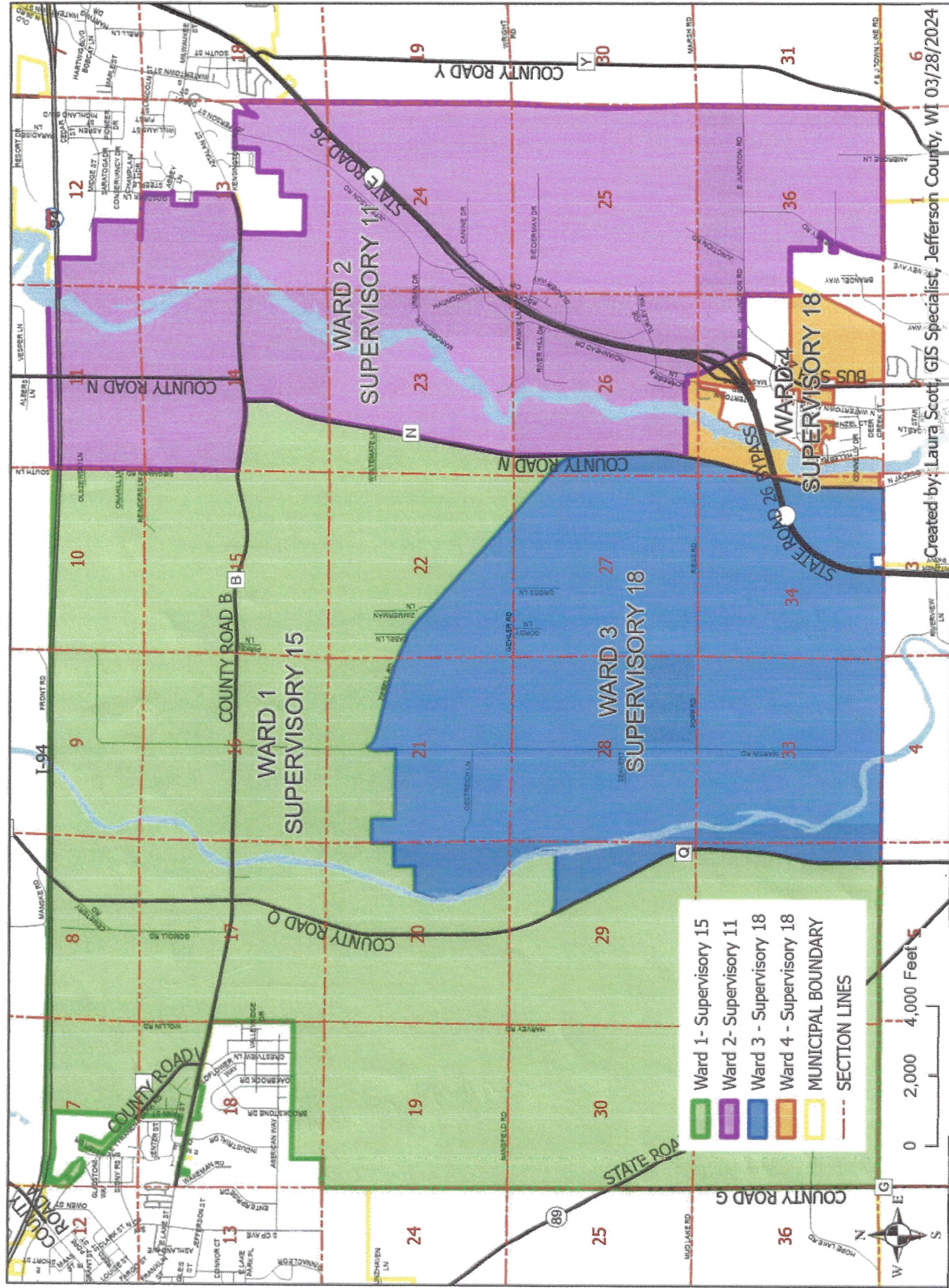



# Town of Aztalan Wards 4/10/2024

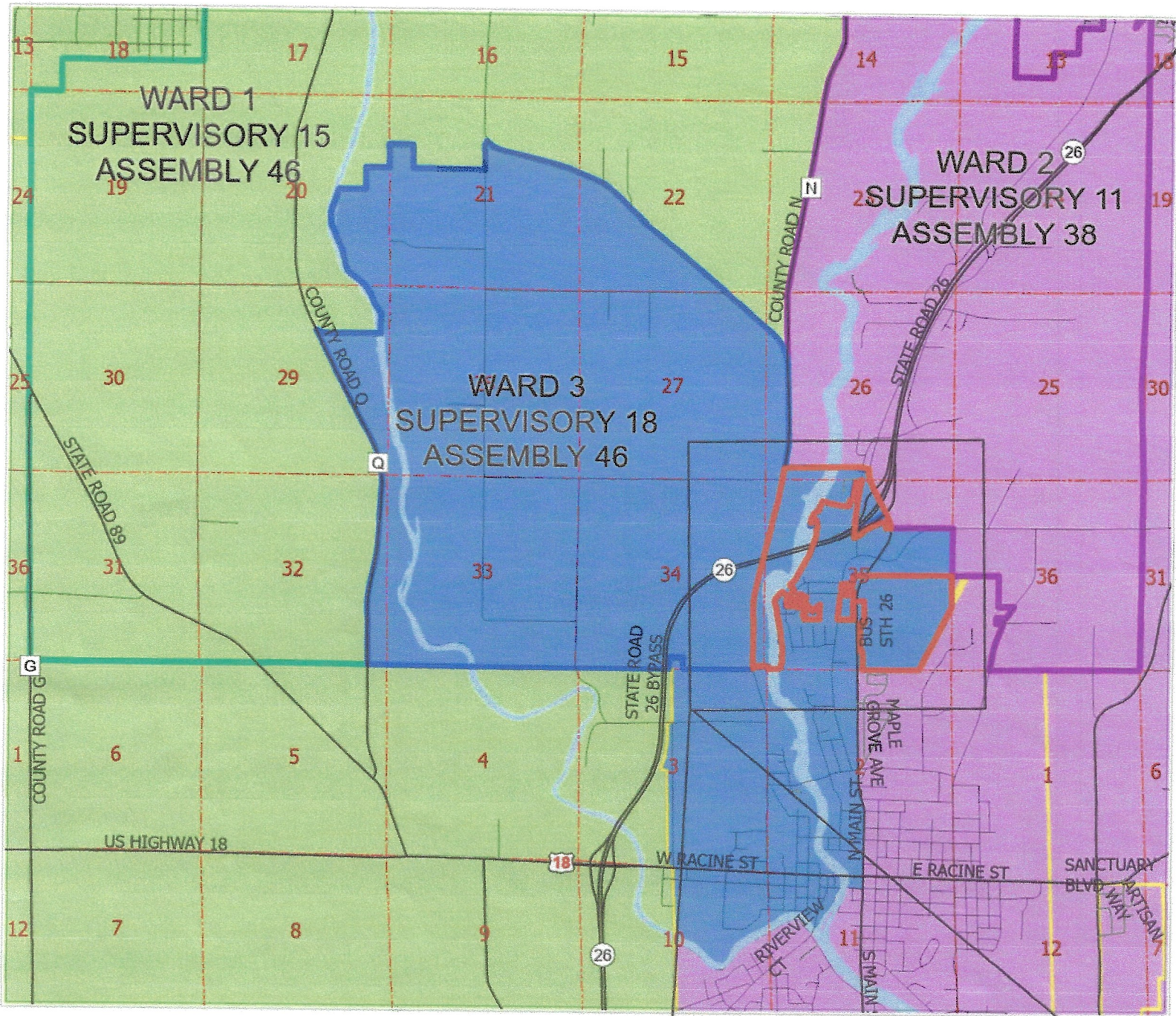

## Assembly Districts

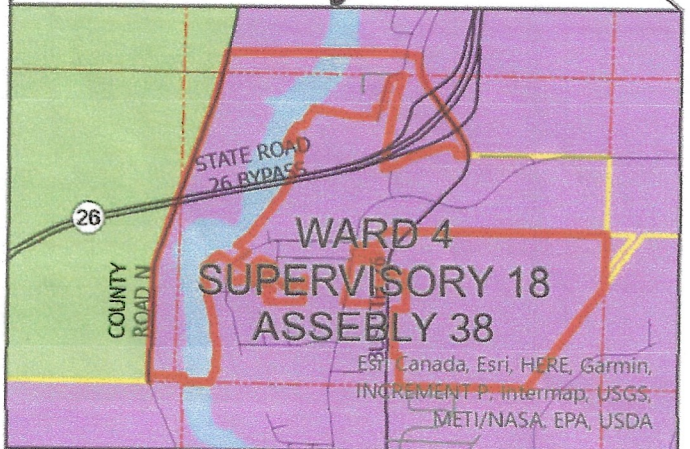

- Ward 1- Supervisory 15 - Assembly 46
- Ward 2- Supervisory 11 - Assembly 38
- Ward 3- Supervisory 18 - Assembly 46
- Ward 4 - Supervisory 18 - Assembly 38
- Supervisor 18
- SECTION LINES
- Assembly District 38
- Assembly District 46
- City Town and Village Boundaries

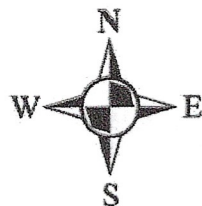

0 2,000 4,000 Feet

ESRI, Canada, Esri, HERE, Garmin,  
INCREMENT P, Intermap, USGS,  
METI/NASA, EPA, USDA



# Town of Aztalan Wards 4/10/2024

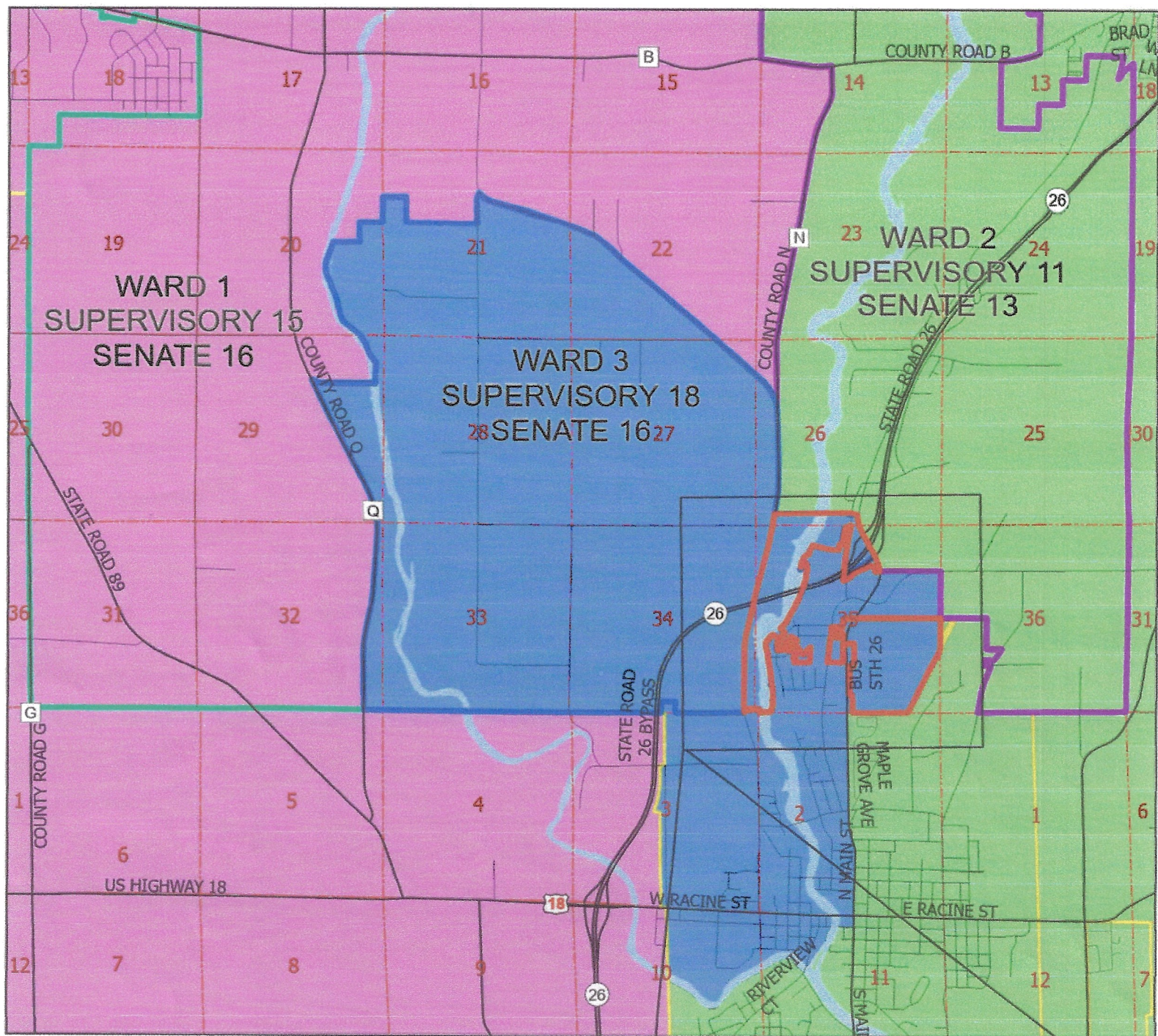

- Ward 1- Supervisory 15 - Senate 16
- Ward 2- Supervisory 11 - Senate 13
- Ward 3- Supervisory 18 - Senate 16
- Ward 4- Supervisory 18 - Senate 13
- Supervisor 18
- SECTION LINES
- Senate District 13
- Senate District 16
- City Town and Village Boundaries

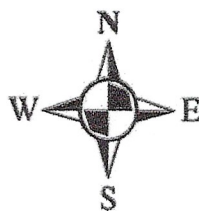

0 2,000 4,000 Feet

## Senate Districts

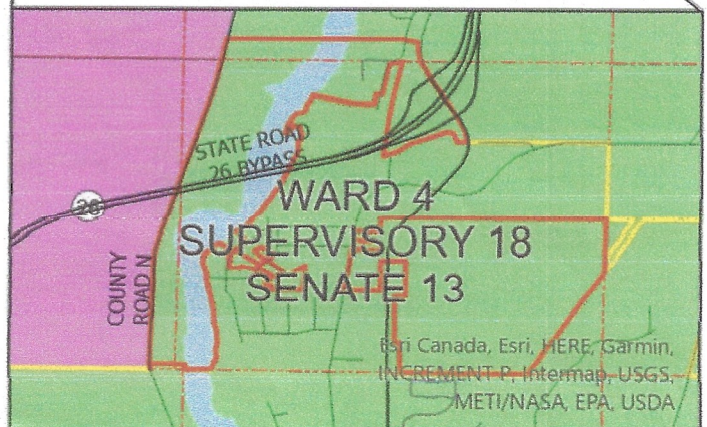

Esri Canada, Esri, HERE, Garmin, INCREMENT P, Intermap, USGS, METI/NASA, EPA, USDA



## EXHIBIT B

**Ward One** — Which shall be a portion of Supervisor District 15. All that part of the Town of Aztalan lying westerly of the following described line: Beginning at the East  $\frac{1}{4}$  Corner of Section 10, Township 7 North, Range 14 East thence south along the east line of said Section 10 and Section 15 to the centerline of County Road B, thence east along said centerline of County Road B to the centerline of County Road N, thence south on said centerline of County Road N to the intersection with the centerline of Ziebell Rd, thence northwesterly on said centerline of Ziebell Rd to the centerline of Popp Rd, thence south on the centerline of Popp Rd to the south line of the north half of the southwest quarter of the northwest quarter of Section 21, Township 7 North, Range 14 East, thence west along said line to the west line of the east half of the southwest quarter of the northwest quarter, thence north on said west line to the north line of the southwest quarter of the northwest quarter, thence west on the north line of the southwest quarter of the northwest quarter to the west corner of the southwest quarter of the northwest quarter, thence south to the south line of the north  $\frac{1}{2}$  of the southeast quarter of the northeast quarter of Section 20, Township 7 North, Range 14 East, thence west 660 feet, thence south 600.6 feet, thence west to the centerline of the Crawfish River, thence south on said centerline of Crawfish River to the south line of the north  $\frac{1}{2}$  of the northeast quarter of Section 29, Township 7 North, Range 14 East, thence west to the north line of the Wisconsin DNR bike trail, thence, northwesterly along said north line to the centerline of County Road Q, thence south along the centerline of County Road Q to the south town boundary and point of terminus.

**Ward Two** — Which shall be a portion of Supervisor District 11. All the part of the Town of Aztalan lying east of the following described line: Beginning at the East quarter corner of Section 10, Township 7 North, Range 14 East, thence south along the east line of Section 10 and 15 to the centerline of County Road B, thence east along the centerline of County Road B to the centerline of County Road N, thence south the centerline of County Road B to the north line of the Wisconsin DNR bike trail, thence east on the north line of the Wisconsin DNR bike Trail to the centerline of Indianhead Dr, thence southeasterly on the centerline of Indianhead Dr to the centerline of Business State Road 26, thence south on the centerline of Business State Road 26 to the north line of the south half of the northeast quarter of Section 35, Township 7 North, Range 14 East, thence east on said north line of the south half of the northeast quarter to the east line of Section 35, Township 7 North, Range 14 East, thence south on the East line of Section 35 to the East Quarter corner of Section 35, Town 7 North Range 14 East, thence east to the northeast corner of the northwest quarter of the southwest quarter, thence south 870 feet, thence east to the centerline of N Dewey Ave, thence south on the centerline of N Dewey Ave to the south town boundary and point of terminus.

**Ward Three**— Which shall be a portion of Supervisor District 18. All the part of the Town of Aztalan lying south of the following described line: beginning at the intersection of the South town boundary and the centerline of County Road N, thence northerly on said centerline of County Road N to the intersection with the centerline of Ziebell Rd, thence northwesterly on said centerline of Ziebell Rd to the centerline of Popp Rd, thence south on the centerline of Popp Rd to the south line of the north half of the southwest quarter of the northwest quarter of Section 21, Township 7 North, Range 14 East, thence west along said line to the west line of the east half of the southwest quarter of the northwest quarter, thence north on said west line to the north line of the southwest quarter of the northwest quarter, thence west on the north line of the southwest



## EXHIBIT B

quarter of the northwest quarter to the west corner of the southwest quarter of the northwest quarter, thence south to the south line of the north  $\frac{1}{2}$  of the southeast quarter of the northeast quarter of Section 20, Township 7 North, Range 14 East, thence west 660 feet, thence south 600.6 feet, thence west to the centerline of the Crawfish River, thence south on said centerline of Crawfish River to the south line of the north  $\frac{1}{2}$  of the northeast quarter of Section 29, Township 7 North, Range 14 East, thence west to the north line of the Wisconsin DNR bike trail, thence, northwesterly along said north line to the centerline of County Road Q, thence south along the centerline of County Road Q to the south town boundary and point of terminus.

**Ward Four**— Which shall be a portion of Supervisor District 18. All the part of the Town of Aztalan lying south of the following described line: beginning on the south boundary line and the centerline of County Road N, thence northerly on said centerline of County Road N to the north line of the Wisconsin DNR bike trail, thence east on the north line of the Wisconsin DNR bike Trail to the centerline of Indianhead Dr, thence southeasterly on the centerline of Indianhead Dr to the centerline of Business State Road 26, thence south on the centerline of Business State Road 26 to the north line of the south half of the northeast quarter of Section 35, Township 7 North, Range 14 East, thence east on said north line of the south half of the northeast quarter to the east line of Section 35, Township 7 North, Range 14 East, thence south on the East line of Section 35 to the East Quarter corner of Section 35, Town 7 North Range 14 East, thence east to the northeast corner of the northwest quarter of the southwest quarter, thence south 870 feet, thence east to the centerline of N Dewey Ave, thence south on the centerline of N Dewey Ave to the south town boundary and point of terminus.